



TRANSPIRA

POWERED BY



## CONTENIDO

Unidad de comunicación



Sensor

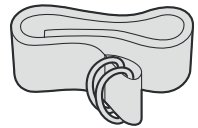

Banda textil  
x2

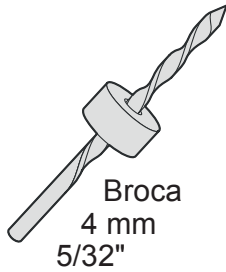

Broca  
4 mm  
5/32"



Imán

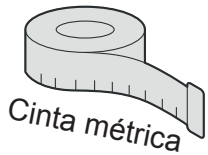

Cinta métrica

2

## HERRAMIENTA REQUERIDA



Smartphone

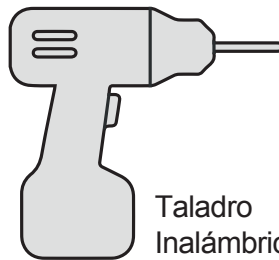

Taladro  
Inalámbrico

3

## RECIBIR UBICACIÓN

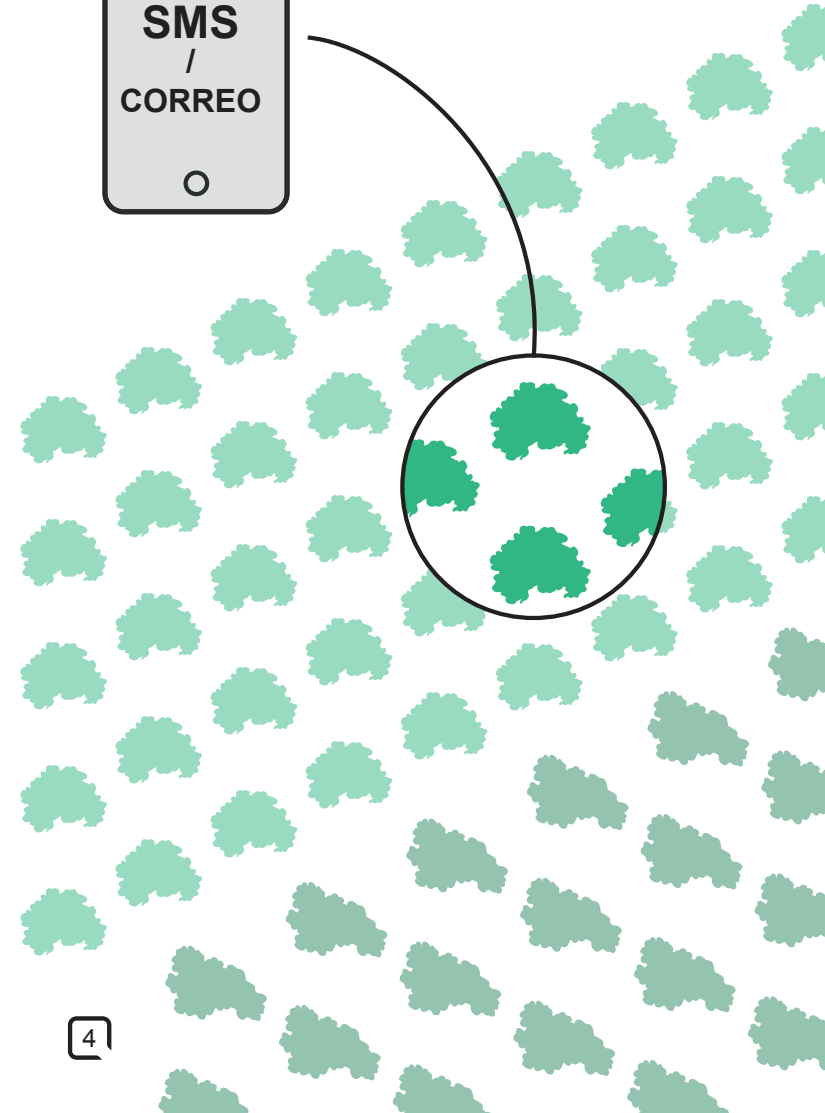

4

## SELECCIONAR UN ÁRBOL SALUDABLE

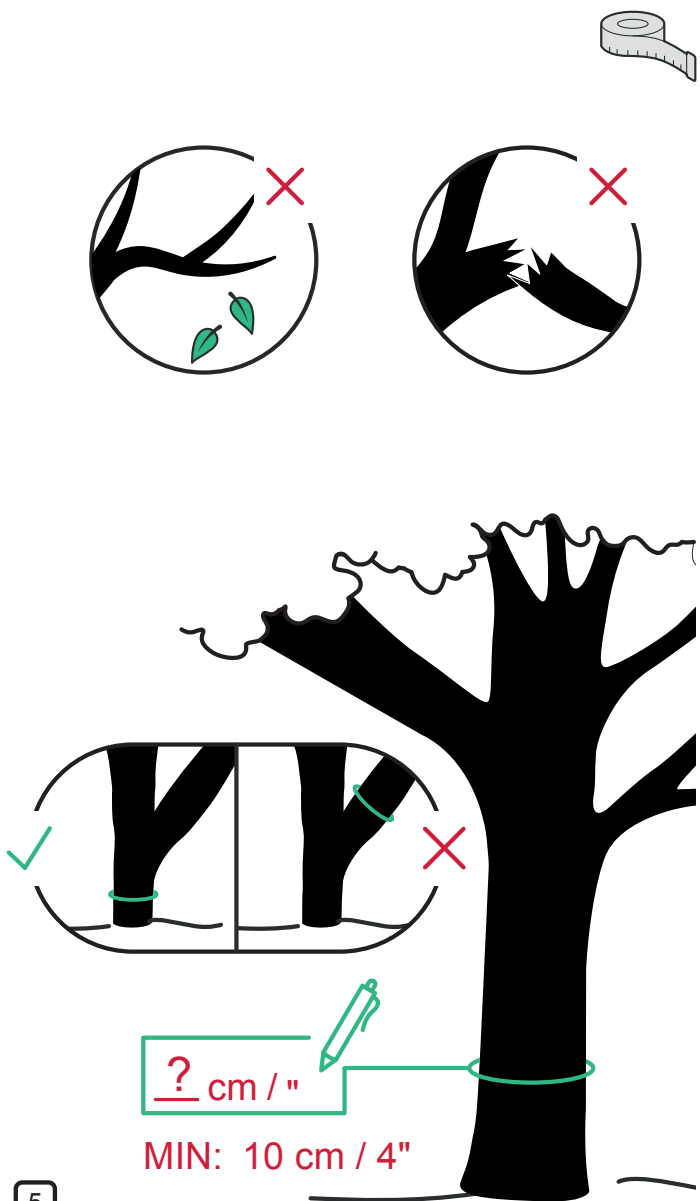

5

## CONECTAR

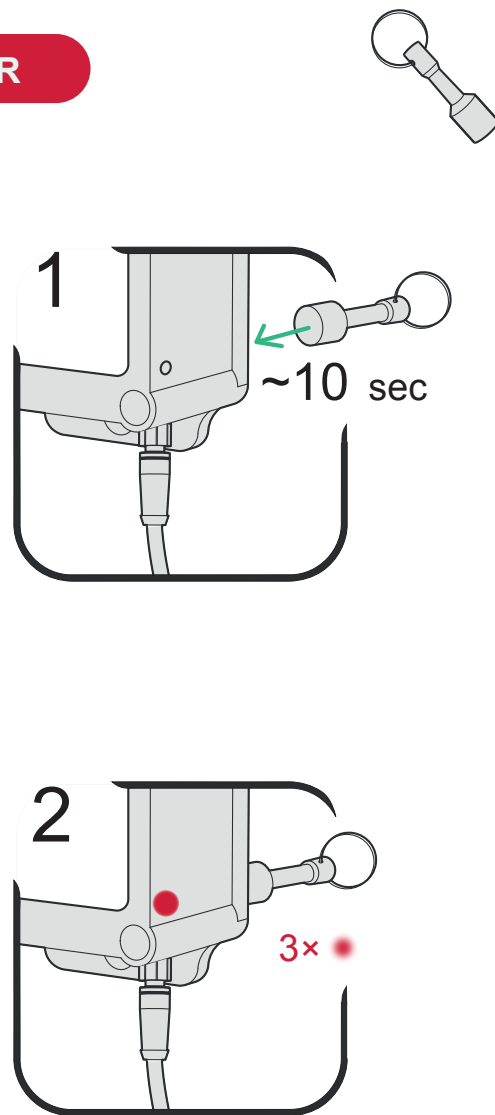

6

## BÚSQUEDA DE RED

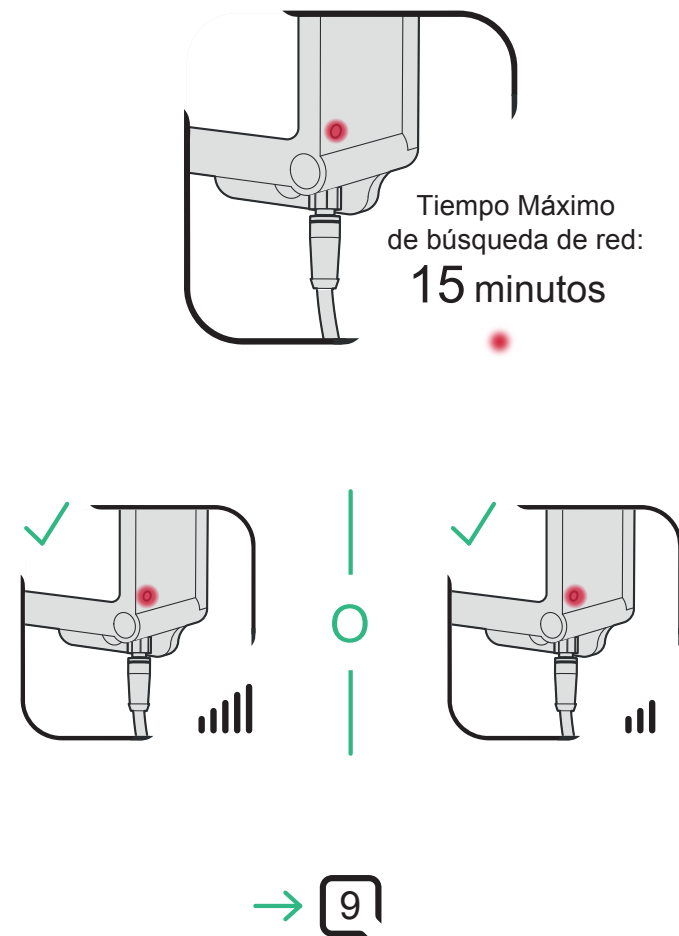

7

## BÚSQUEDA DE RED

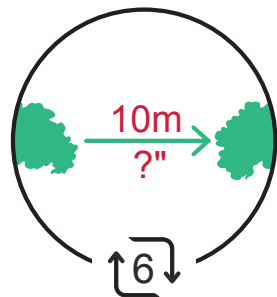
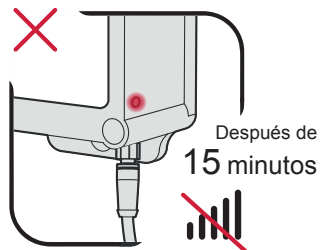

Después de 2 búsquedas



8

## LOCALIZACIÓN DEL SENSOR

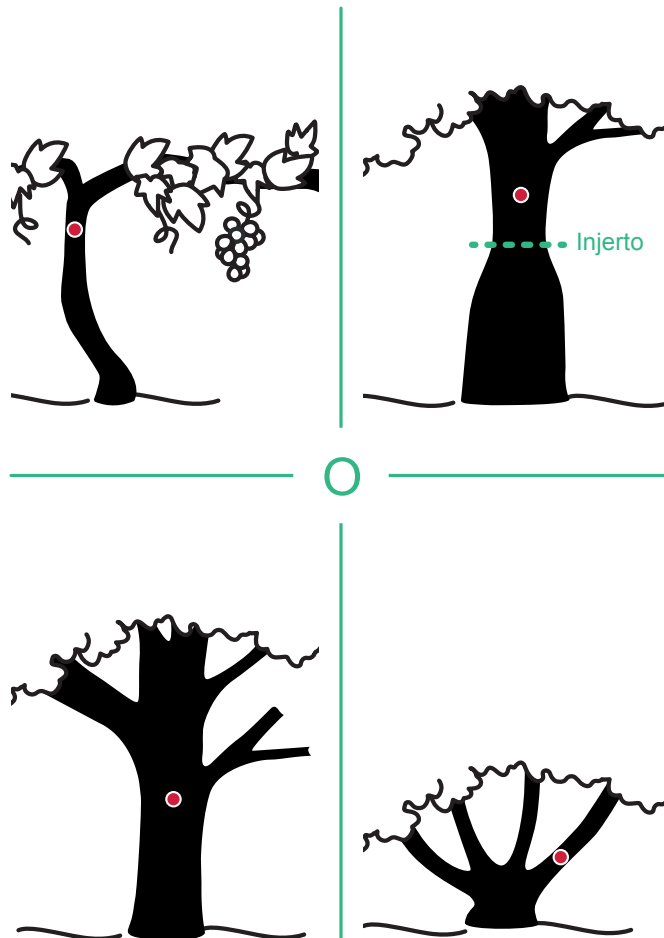

9

## LOCALIZACIÓN DEL SENSOR

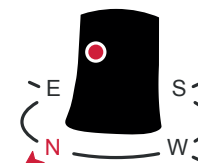
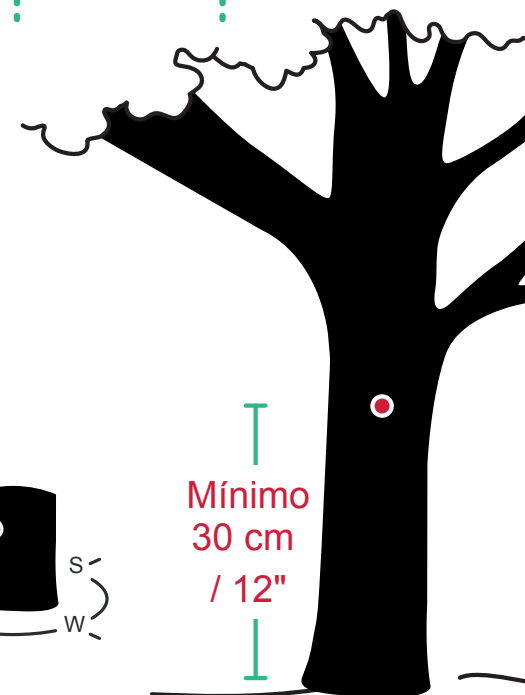
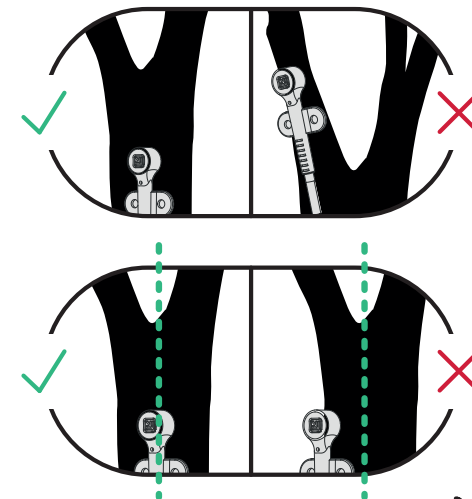

10

## INSTALACIÓN DE LA UNIDAD DE COMUNICACIÓN

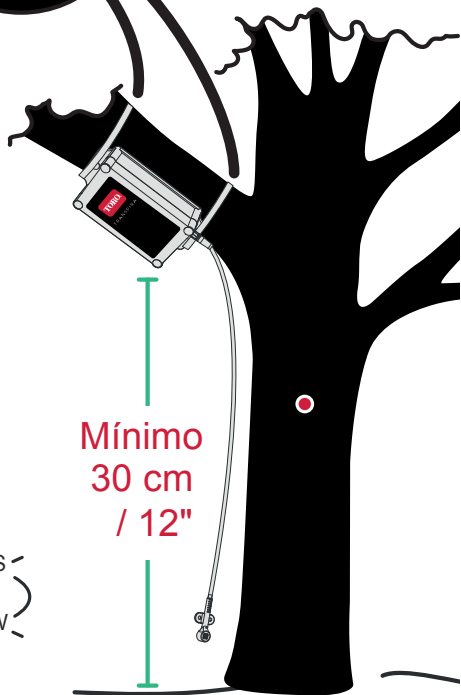
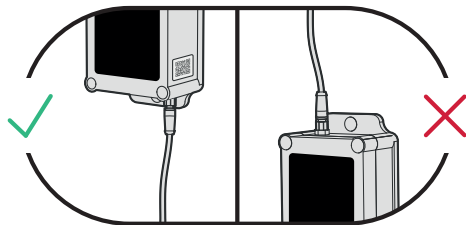

Mínimo  
30 cm  
/ 12"

11

## INSTALACIÓN DEL SENSOR

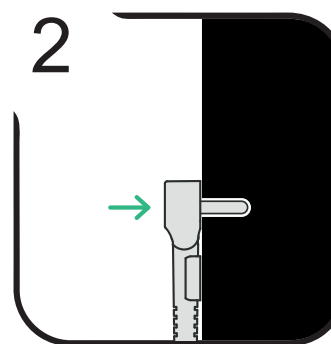
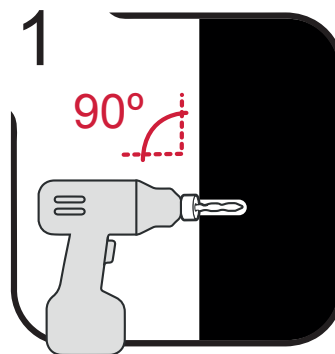
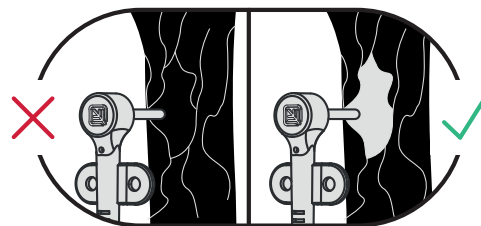
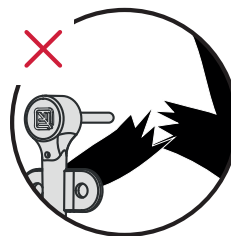
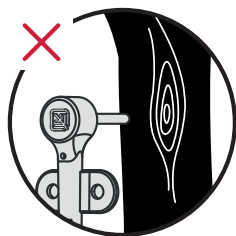

12



## INSTALACIÓN DEL SENSOR

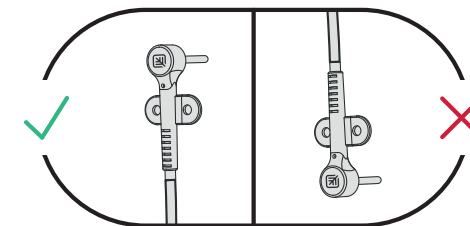
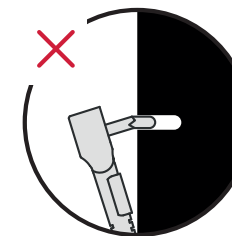
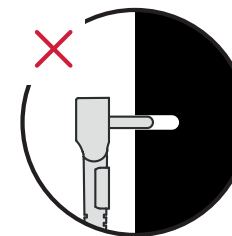

13

# INSTALACIÓN DE APP



1

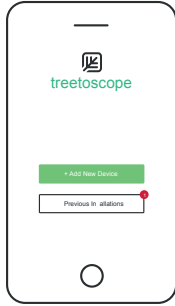

2



3

